

Ventilator and Canopy Assembly

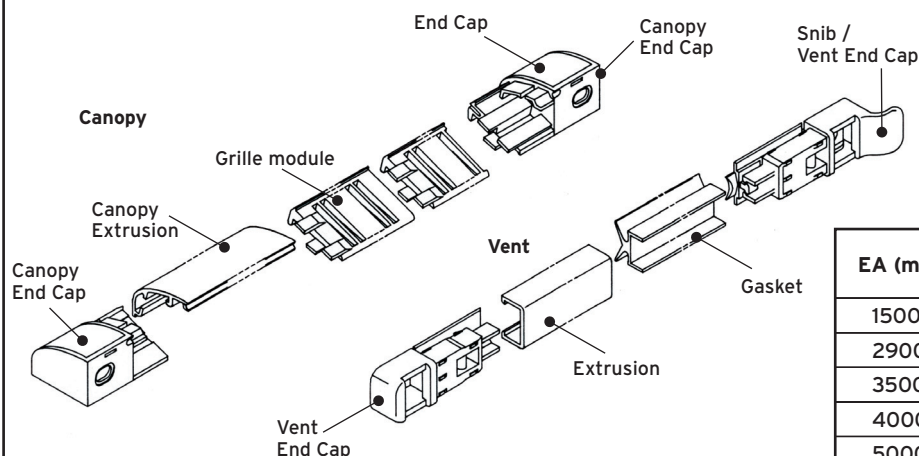

EA (mm ²)*	Free Area (mm ²)	Overall Length	
		Vent length	Canopy length
1500 *	2000 *	314	302
2900 **	4000 **	457	445
3500 *	4000 *	544	532
4000 **	6000 **	635	588
5000 **	6750 **	700	705

* = 10mm Slot Width, ** = 12mm Slot Width

Figure 1

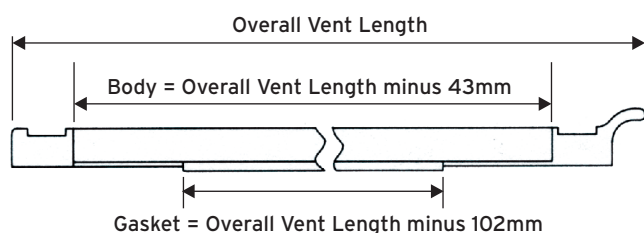

Ventilator Assembly Details

1. Using the calculation, cut suitable length of vent and gasket extrusion to required length (See Figure 1).
2. Push in one end cap, slide gasket into opposite end and push in second end cap.
3. Using a suitable piece of wood to support the ventilator, crimp underside of extrusion in the positions shown using crimping tool and a hammer to lock end caps into position (See Figure 2).
4. Assemble links and feet to end caps (See Figure 3).
5. Affix correct EA sticker.
6. Follow Fixing Instructions overleaf.

Figure 2

Underside of Ventilator. Crimp with crimping tool where indicated.

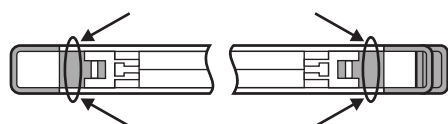

Crimping tool available free of charge to customers and is available on request.

Cross-section: Strike crimping tool with hammer into extrusion to lock end caps in position.



Figure 3

Assemble Links and Feet after crimping extrusion to end pieces.

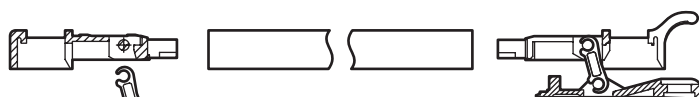

Non-snib end

Snib end

Canopy Assembly

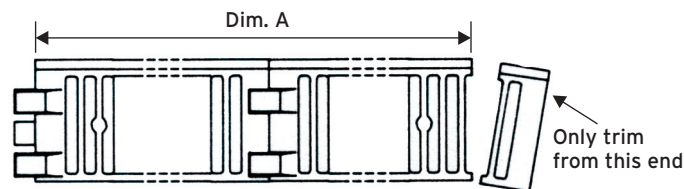

Components per Canopy

Canopy Length (mm)	No. of grilles	No. of Centre Clips
0-301	1	0
302-532	2	1
533-762	3	1

Canopy Assembly Details:

1. Measure and cut canopy extrusion using the calculation:
Extrusion Length = Overall Canopy Length minus 40mm
Overall Grilles (Dim. A) = Overall Canopy Length minus 72mm
2. Fit end cap to one end.
3. Slide in grille modules, trimming last one as required.
4. Fit second end cap.
5. Follow Fixing Instructions overleaf.

EA = Equivalent Area.

All dimensions in mm unless otherwise stated.

Tested in accordance with BS:EN 13141-1 (2004).

MARKETING DIVISION

International House, Peartree Road, Stanway, Colchester, Essex CO3 0JL

Tel: +44 (0) 1206 713800 Fax: +44 (0) 1206 543126 Web: www.titon.com

Ventilator and Canopy

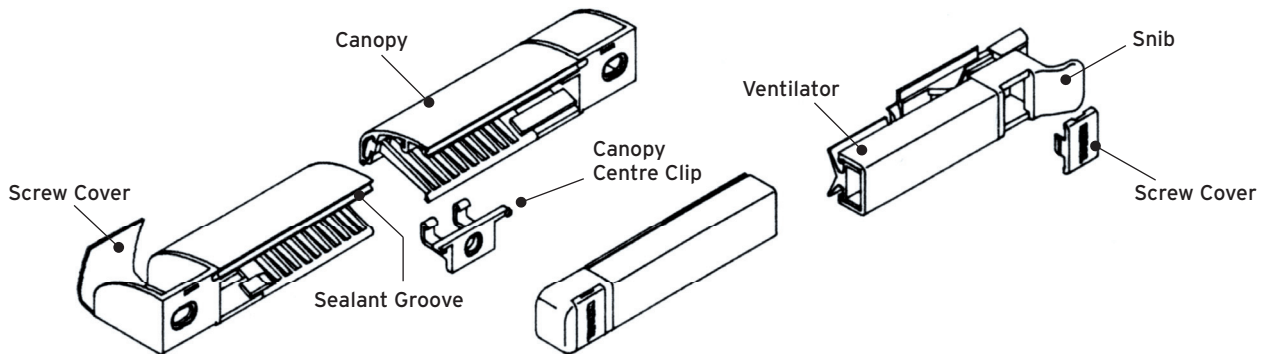

Figure 1

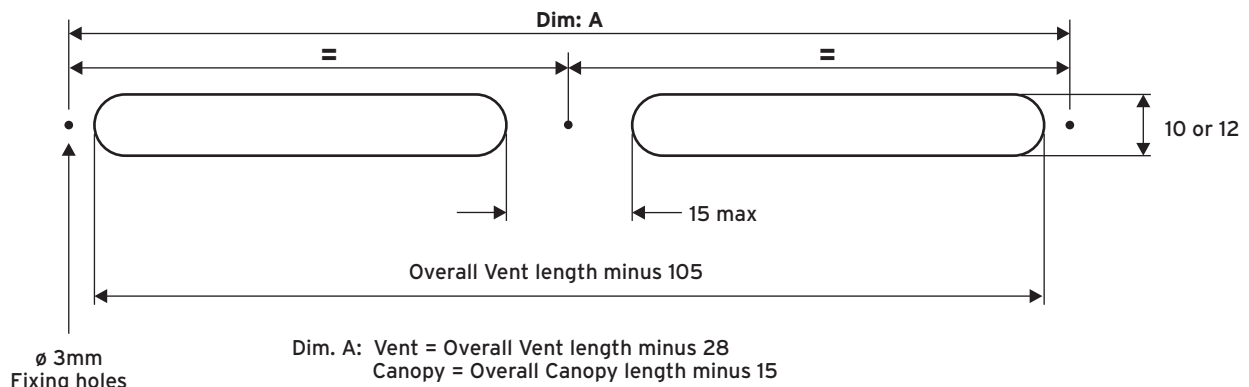

Figure 2

Ensure Vent is fully closed before fixing.

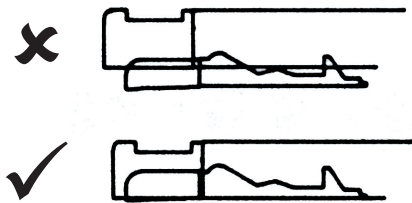
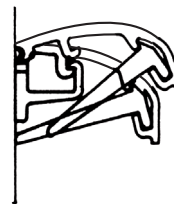

Figure 3

Clip Canopy onto centre clip



Fixing Details

1. Prepare slots and fixing holes, avoiding glazing rebates and reinforcement (See Figure 1).
2. Fix vent and insert screw covers. Ensure vent is fully closed before fixing (See Figure 2).
3. Fix canopy centre clip and clip on canopy (See Figure 3).
4. Open canopy screw covers and fix canopy. Close screw covers.

We recommend the use of a good quality silicone sealant along the canopy sealant groove.

Recommended fixing screws: No.6 pan head, self tapping.

EA = Equivalent Area.

All dimensions in mm unless otherwise stated.

* Any significant variation of the applications shown will affect the EA performance of the product combination.
Tested in accordance with BS:EN 13141-1 (2004).

MARKETING DIVISION

International House, Peartree Road, Stanway, Colchester, Essex CO3 0JL
Tel: +44 (0) 1206 713800 Fax: +44 (0) 1206 543126 Web: www.titon.com