

Capture Restrictor

Fitting and Operating Instructions

The Capture Restrictor is suitable for open out casement windows. Please ensure you choose the correct handing for your window Restrictor.

Choosing your Handing (based on viewing your window from the inside)

Top hung window - you will require the same handing as the side you wish to install the Restrictor, i.e. a right handed Capture for installation on the right hand side.

Side hung window - you will require the same handing as the side the hinge is on, i.e. a left handed Capture for a window that has it's hinge on the left hand side.

Dimensions

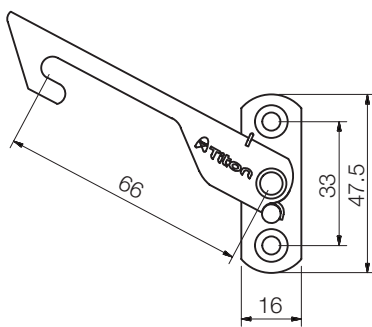

Capture Restrictor LH - Short

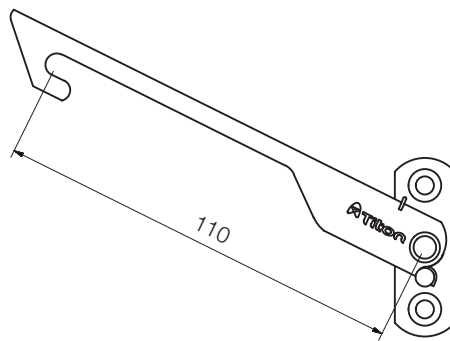

Capture Restrictor LH - Medium

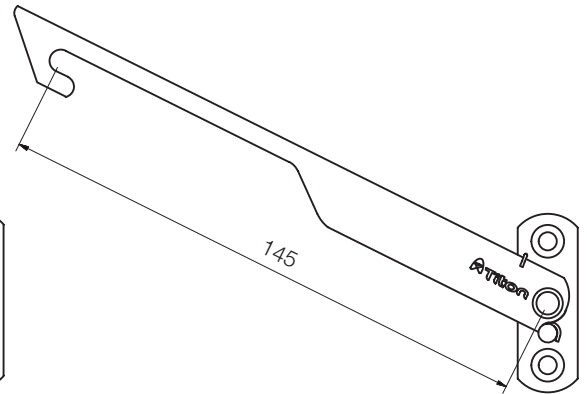

Capture Restrictor LH - Long

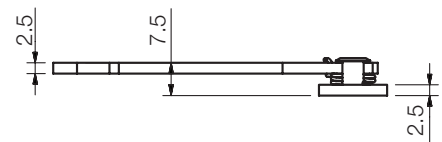
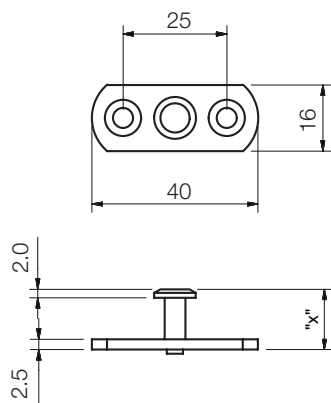

Pin Selection

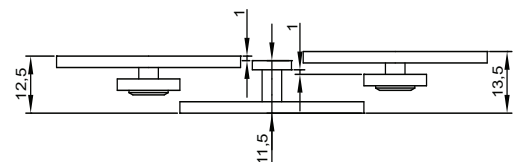
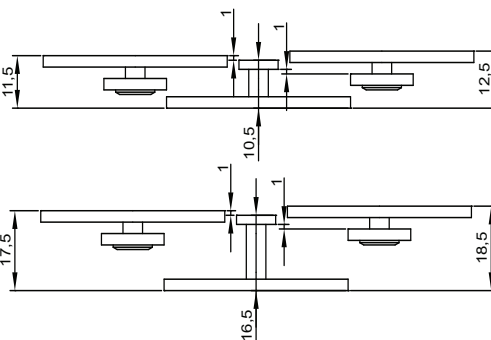
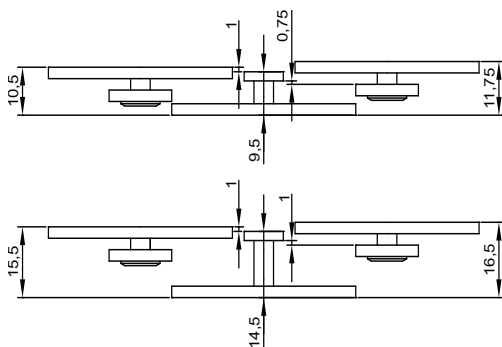

All dimensions in mm

Fitting

Please note that these steps show a right hand side hung set up. We recommend that the Capture should be fitted with stainless steel screws only.

Orientation of the components;

The arm should be pointing away from the hinge, towards the opening.

The Capture hook should always be fitted on the sash, and the Capture pin should always be fitted to the frame of the window.



The Capture Restrictor should be positioned to limit the window opening, generally to a maximum of 100mm (ref BS8213-1).

The correct height post must always be used. However, it may be necessary to gently bend the arm to ensure it locates midway on the post and does not snag the sash frame. It is essential to check the restrictor for correct operation after window installation.

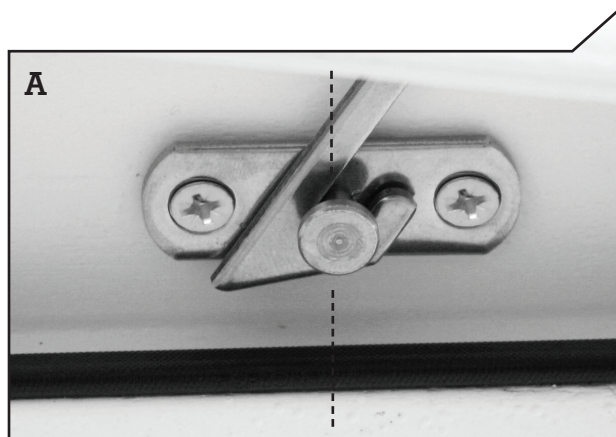
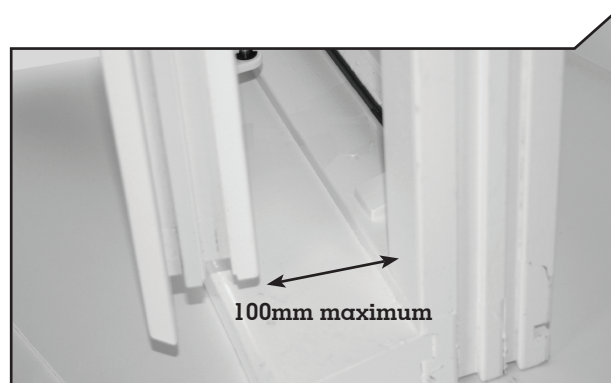

With the window open to the required position, fix the arm and pin as shown in picture A. The hook and pin are generally fitted on the same centre line as the friction hinge as shown in picture B.

Operating

Opening the window will automatically engage the Restrictor. To release follow the next stage.



Pull the window towards you (approx. 20mm). This will enable the hook to be moved away from the pin. Whilst holding the hook in this position, open the window.

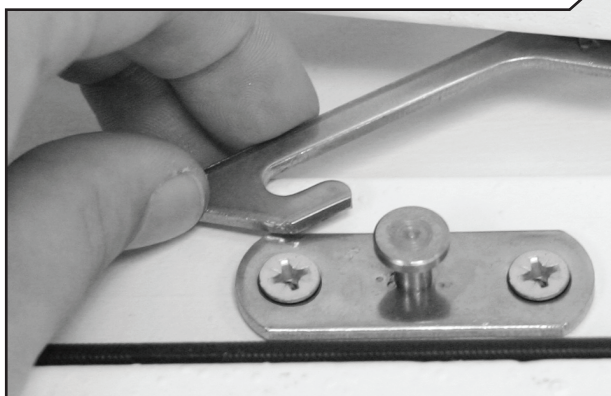

Upon closing the window, the Restrictor will reposition to restrict the window automatically when re-opened.

