

# Maco Multi Matic

## Tilt and turn hinge system

Suitable for:

PVCu



ALUMINIUM



TIMBER



**Tilt and turn window gear (tilt before turn) for windows up to 1630mm wide, 2250mm high and sash weights up to 130kg.**

Maco Multi Matic is open in only, has a tilt mode position for ventilation and a turn mode for cleaning. An enhanced security version is available to comply with PAS 24. Also available with concealed hinges (Matic Invisible).



Tilt position for ventilation



Closed position

## Features and Benefits

- Symmetrical hinge positions for easy fitting
- Anti-slam device
- Three dimensional hinge adjustment
- Adjustable sash lifter prevents sash drop
- No hinge contact with water bar to improve thermal resistance
- Eurogroove fixing corner support allows for decorative rebate edge
- High security version available
- Fits smaller mullion profiles



Turn position for cleaning

### Size capacity

Sash widths 220 – 1630mm

Sash heights 470 – 2250mm

For sizes close to these limits, phone for details

### Weight capacity

Maximum sash weight – PVCu 100-120kg (depending on hinge type), timber 130kg

### Manufactured from

Mild steel

### Standards

BS EN 1670 Class 5

### Finish

Silver Chromate

Tricoat (high corrosion resistance) also available (Subject to availability)

### Recommended screws

4mm/No.8 countersunk head

Handle fitting – M5 machine screw or suitable alternative

For Tricoat finish ensure Tricoat screws are used

### More information

[enquiries@titon.co.uk](mailto:enquiries@titon.co.uk) / 01206 713801

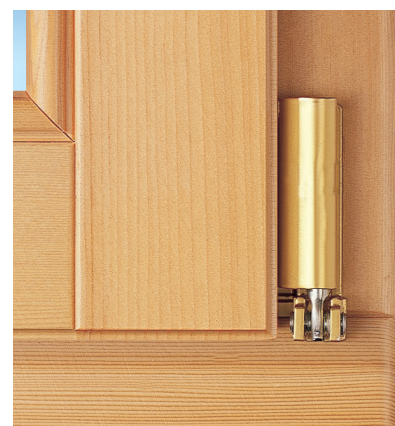
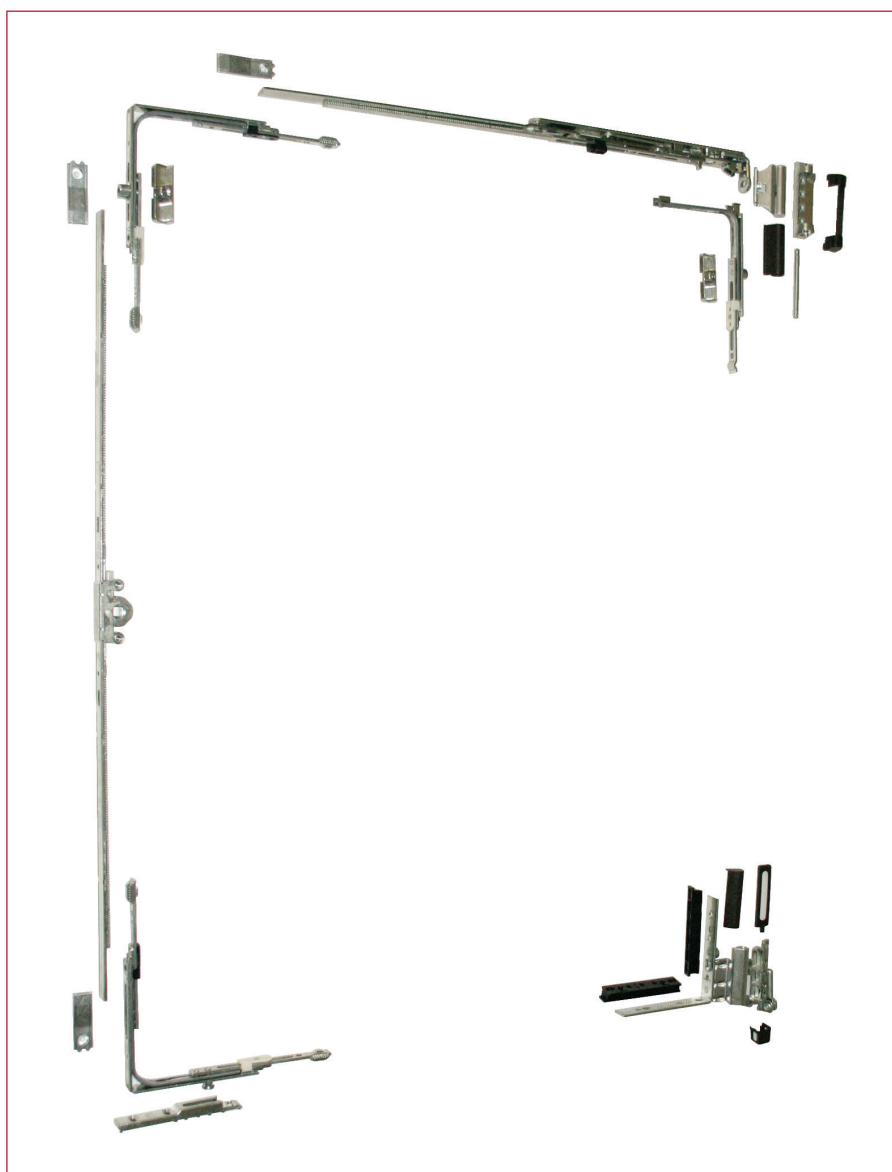

Bottom hinge - Timber



Bottom hinge - PVCu