

# Titon Ultimate® dMEV

Decentralised Mechanical Extract Ventilation  
or constant flow intermittent extract fan

## For use in residential dwellings and light commercial applications

The new high performing Titon Ultimate® dMEV is an ultra quiet low profile fan, which is suitable for new build or refurbishment projects. It can be either wall or ceiling mounted and is ideal for bathrooms, kitchens and utility room applications.

With adjustable continuous and boost speed settings available. The patent applied fan utilises an efficient DC motor and uniquely designed impeller/guide vane combination to produce high flow rates and pressure.

The Titon Ultimate® dMEV uses a boost overrun and boost delay timer that is adjustable between 0 - 60 minutes. The unit has optional humidity control, constant flow and optional data logging.



For use with Titon Trickle Ventilators.

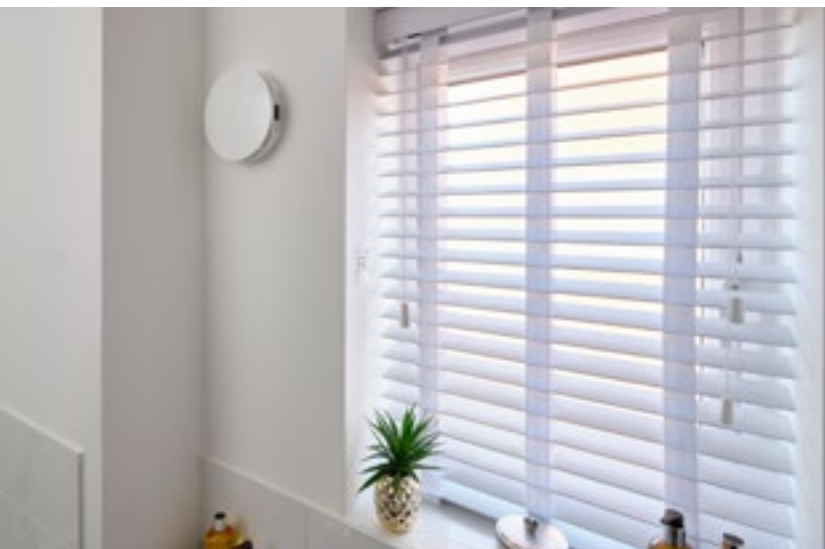

## Features & Benefits

- One of the quietest solutions and best performing dMEV fan on the market
- PCDB listed for inclusion within SAP (Consp10/SAP10 compliant)
- Low specific fan power down to 0.11 W/l/s
- Airflow up to 30 l/s (108 m³/h)
- Extremely low running costs
- 3 configurable speed options (Trickle, Boost and High Boost)
- Eligible for Energy Compliance Obligation (ECO) fourth iteration funding
- Constant flow technology
- 4 button & LED display to allow for simple control
- Extract fan designed to run continuously (24/7)
- Integral pressure sensor to maintain constant flow to overcome external back pressures of up to 20Pa
- Unit running time and average RH Data Logging
- Fast straightforward commissioning and set up
- CFC Ceiling Fan Cuff available. Independently tested to BS EN 1364-2: 2018 Fire Resistance Tests for non-load bearing elements – Part 2: Ceilings and additional guidance from BS EN 1366-3: 2009. (Test Report 510322B/R). Up to 60 minutes integrity and insulation
- Ideal for removing condensation which can lead to mould and ill health
- Low profile aesthetic circular design
- Quiet running, only 10 dB(A) at 3m, low speed
- Unique high performance impeller and guide vane design
- IPX4 rated (Ceiling mounted TP646 Kit required)\*
- Double insulated (requires no earth)
- Designed and manufactured in accordance with EN60335-2-80 Low Voltage Directive and the EMC Directive (Electromagnetic Compatibility)
- Display in l/s or m³/h
- Intermittent function
- Humidity control suspend timer
- Unit lock out button for installers/landlords
- Complies with Building Regulations Part F (England and Wales)
- Exceeds newly proposed stringent 20 Pa back pressure requirement

\* To maintain the IPX4 rating when ceiling mounted, a kit must be used. Please contact Titon for availability of ceiling mounting kits.

*The Ultimate Choice*

## Description

Titon Ultimate® dMEV constant flow decentralised mechanical extract ventilation fan.

## Product Codes

**TP640i** – Basic version

**TP640Hi** – Humidity Control

**TP640Hdi** – Humidity Control with Data Logging

## Standards

Designed and manufactured in accordance with EN60335-2-80 (Low Voltage Directive) and the EMC Directive (Electromagnetic Compatibility).  
Air performance measured according to ISO 5801 at 230V 50Hz, air density 1,2 Kg/m<sup>3</sup>.  
CE and UKCA marked.

## Specification

**Dimensions:** Ø195mm with 45mm projection

**Weight:** 0.5Kg

**Finish:** Gloss White

**Materials:** ABS, PCB's, LED display & brushless motor.

**Controls:** Onboard 4 button controls with 4 digit LED display

**Guarantee period:** 18 months (UK only)

**Electrical:** 220-240 V ~ 50/60Hz

**Installation:** To be installed accordance with the relevant and applicable building regulations.

**Maintenance:** Service, clean, replace subject to local environment - see product manual.

## Accessories

**TP645/BR** - Telescopic Wall Kit (Brown)

**TP645/BE** - Telescopic Wall Kit (Beige)

**TP645/TC** - Telescopic Wall Kit (Terracotta)

**TP645/WH** - Telescopic Wall Kit (White)

**TP646** - IPx4 Ceiling Kit

**TP647** - Decorative Wall Plate

**CFC100** - CFC Ceiling Fan Cuff

**QSS310** - Quelstop Acrylic Sealant

## Ducting Kits

Our ducting kits are recommended to maintain flow rates and are available in Ø100mm and 110x54mm rectangular. Kits contain; 3m duct, bends, grille and accessories. Calculated resistance rates are also included in ducting kit literature.

## Drawing & Dimensions

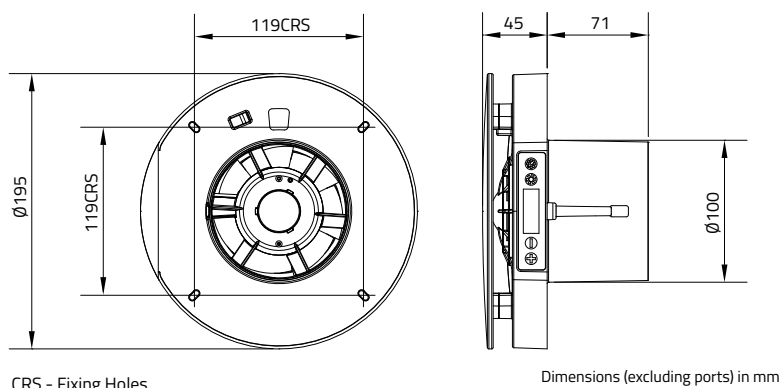

CRS - Fixing Holes

Dimensions (excluding ports) in mm

Ceiling IPX4 Kit\*  
**(TP646)**

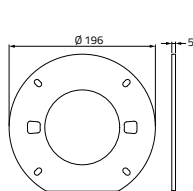

Decorative Wall Plate  
**(TP647)**

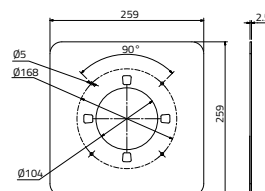

\* To be used with Window Kits TP203 & TP204

## Performance

The results detailed below have been determined from independent laboratory testing performed in accordance with the latest SAP10 dMEV (Consp10) test standard introduced on 15th June 2022. Tests were performed with rigid ducting.

		Ducted in Room					Through Wall	
		Kitchen		Wet Room			Kitchen	Wet Room
Fan Speed Setting	l/s	13	16	5	8	11	13	8
SFP	w/l/s	0.15	0.16	0.21	0.15	0.15	0.11	0.14
Volume reduction with 20Pa back pressure	%	1	2	6	5	2	1	1
Max volume reduction allowed	%	30	30	30	30	30	30	30
Power	W	1.89	2.52	1.07	1.23	1.60	1.47	1.13
Noise Level	dBA @ 3m	28**		19**			26	15

Figures taken from the BRE Test Results.

\*\*Using 100mm diameter round duct and tested in accordance with SAP PCDB method V2.0:2013.

## Nominal Fan Performance

